

Central to Eveleigh

Urban Transformation
and Transport Program

Community Stakeholder Briefing

19 August 2015



Session Agenda



Time	Item	Presenter/s
6:00pm	Acknowledgment of Country	
6:05pm	Welcome and introductions	Lucy Cole-Edelstein Straight Talk (Facilitator)
6:10pm	Report back	Troy Daly UrbanGrowth NSW
6:25pm	Spatial Plans	Troy Daly UrbanGrowth NSW
6:35pm	What do you think?	-
7:10pm	Implementation Plans <ul style="list-style-type: none">- Places and Open Space- Community- Arts, Culture and Heritage	Kerrie Symonds, UrbanGrowth NSW Kerrie Symonds, UrbanGrowth NSW Vanessa Gordon, UrbanGrowth NSW
7:40pm	What do you think?	-
8:15pm	Working together	-
8:45pm	Report back	
9:00pm	Thank you and Close	Troy Daly UrbanGrowth NSW



Acknowledgment of Country





Report Back

Troy Daly



Panel feedback

In principle support for :

- Vision
- Key moves

BUT...

Conditional on more detailed understanding of how:

- Moves would be implemented
- The vision would be realised



Workshop feedback – trade-offs

- More public transport infrastructure and services
- Better accessibility in and around the area
- More affordable homes
- Retention of social housing mixed with private housing
- Excellent building design and quality:
 - minimise overshadowing and overlooking
 - ensure distinctive architecture
- Active street frontages and vibrant retail areas
- More green spaces and community facilities for community interaction
- Sustainable development and green buildings
- Programs to encourage strong sense of community

Workshop feedback – North Eveleigh

Support for:

- Varying building heights with good design
- Reuse of key heritage buildings as community hubs
- Pedestrian and cycle connection across the railway



LIVING



EXPANDED CYCLEWAY NETWORKS.



HOUSING DIVERSITY FROM LIVE / WORK FOR CREATIVES, TO OPTIONS FOR OLDER PERSONS TO REMAIN WITHIN THEIR COMMUNITY.

A PLACE WORLD-RENOUNDED FOR CULTURE AND CREATIVITY



20,000

NEW DWELLINGS



WELL CONNECTED NEIGHBOURHOODS WITH DISTINCT IDENTITIES

NEW HOMES FOR REDFERN & WATERLOO RESIDENTS.



60%

INCREASE IN HOUSING SUPPLY TO ASSIST IN MEETING THE NEEDS OF A SIGNIFICANTLY GROWING POPULATION.

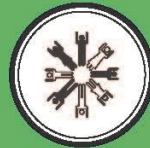

HOUSING CLOSE TO JOBS, TRANSPORT OPTIONS AND SERVICES



This will be a place with a broad supply and choice of homes and active and attractive public places to support diversity

COMMUNITY

9

NEW LONG DAY CARE CENTRES

NEW SYDNEY METRO STATION AT WATERLOO OR UNIVERSITY OF SYDNEY LINKING TO BANKSTOWN AND THE NORTH WEST.



A HUB FOR CONTEMPORARY CULTURE & CREATIVITY IN SYDNEY THAT IS THE PLATFORM FOR CULTURAL EXCHANGE AND MARKET DEVELOPMENT.

ENHANCED DIVERSITY, AFFORDABILITY, CONNECTIVITY & ACCESS.



400

METRES OR 5 MINUTE WALK ACCESS TO PUBLIC OPEN & GATHERING SPACE.



REDEVELOPMENT OF REDFERN STATION AT THE HEART OF A REDFERN STREET HUB

(MORE FROM REDFERN STATION REPORT WHICH WILL BE ABLE TO QUANTIFY THE WIDER PRECINCT ACCESSIBILITY IN TERMS OF % POPULATION WITHIN A 15 MIN WALK CATCHMENT)

RECONNECTING WITH A RICH HISTORY BY REALISING THE EORA JOURNEY AND PRESERVING CULTURAL AND HERITAGE ASSETS.



A NEW SECONDARY SCHOOL (CLEVELAND STREET) AND THE EXPANSION OF ALEXANDRIA PARK SECONDARY SCHOOL.



This will be a place that celebrates our rich diversity and heritage and gives everyone easy access to community and cultural facilities

WORKING



A PLATFORM FOR AUSTRALIA'S DIGITAL & CREATIVE ECONOMY.

15,000



NEW JOBS INCLUDING HIGH VALUE JOBS IN KNOWLEDGE INTENSIVE ORGANISATIONS WITH SPACE THAT ENCOURAGES INNOVATION & EXPANSION.



BETTER OPPORTUNITIES FOR SMALL & MEDIUM ENTERPRISE.

A CREATIVE HUB AT THE HEART OF A DIVERSE LOCAL COMMUNITY. STUDIO & CO-WORKING SPACE THAT PROMOTES DISTRIBUTED WORKPLACES.



NEW LINKS IMPROVING CONNECTIONS BETWEEN THE UNIVERSITY OF SYDNEY, UNIVERSITY OF TECHNOLOGY AND THE AUSTRALIAN TECHNOLOGY PARK AND EORA COLLEGE.



INCREASED PRODUCTIVITY AND EMPLOYMENT OPPORTUNITY THROUGH AGGLOMERATION BENEFITS



WORLD CLASS CULTURAL INFRASTRUCTURE.

NEW RETAIL OPPORTUNITIES ON RENEWED HIGH STREETS.



This will be a place that connects many types of businesses – service trade, digital, education, innovation and creative industries

ENVIRONMENT

53,000

METRES SQUARE OF NEW PUBLIC OPEN SPACE.



SUSTAINABLE INFRASTRUCTURE INCLUDING ENERGY AND WATER ON A DISTRICT SCALE

URBAN DESIGN THAT CELEBRATES HERITAGE & PROMOTES URBAN BIODIVERSITY.



23%

UPTAKE IN CAR SHARE



RESPONDS TO THE BROAD SUSTAINABILITY PRINCIPLES AND STRATEGIC DIRECTIONS OF SUSTAINABLE SYDNEY 2030



ORIENTATION OF BLOCKS TO MAXIMISE SOLAR ACCESS AND OPPORTUNITIES FOR PASSIVE SOLAR DESIGN



LESS POLLUTION BECAUSE OF HIGHER PUBLIC AND ACTIVE TRANSPORT USE



SETTING OF SUSTAINABILITY TARGETS FOR FUTURE DEVELOPMENT



This will be a place that responds to economic, social and climatic changes in ways that benefit our quality of life and the quality of our environment

1. Renew Redfern Station



2. Create a green network



3. Create crossings of the Corridor



4. Connect the city with surrounds

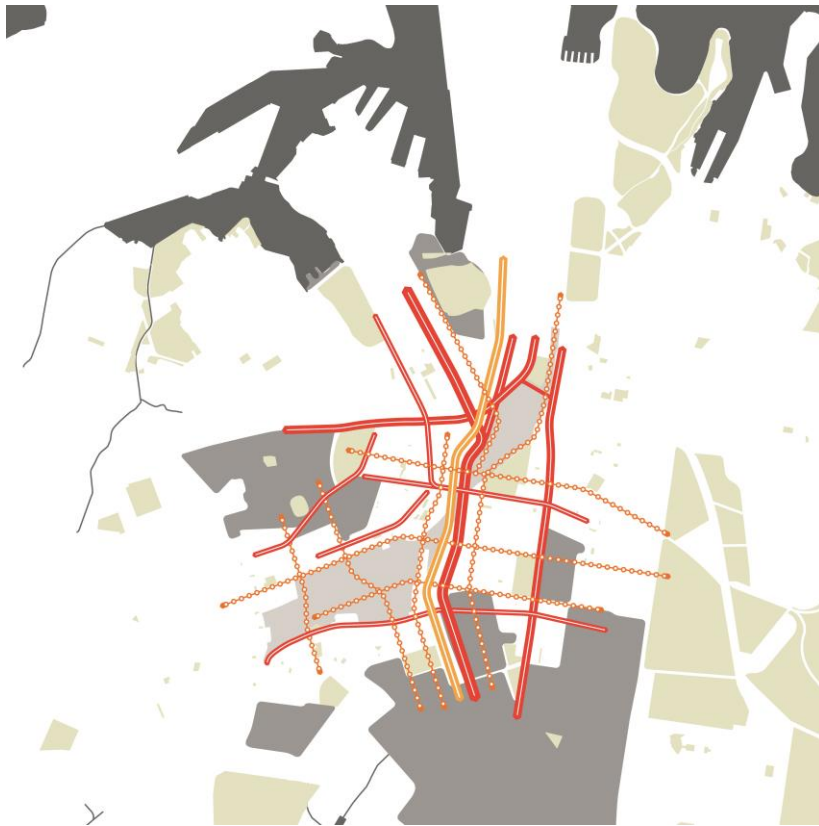

5. Create centres of activity around stations

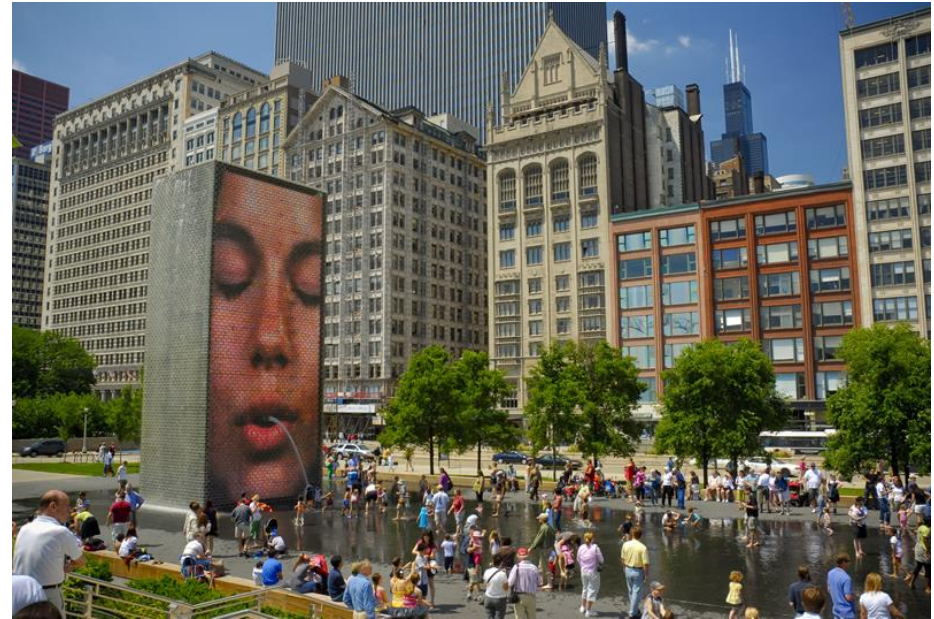

6. Create a centre of Sydney's growing economies

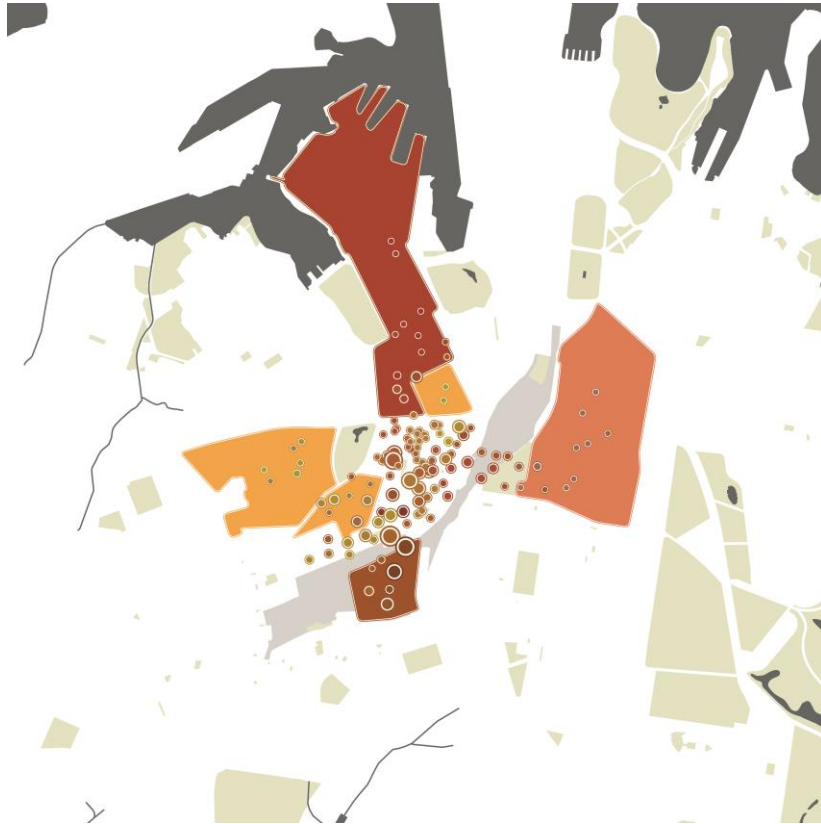

7. Promote live-work environments



8. Strengthen arts, culture & heritage



9. Integrate new tall buildings with surrounds

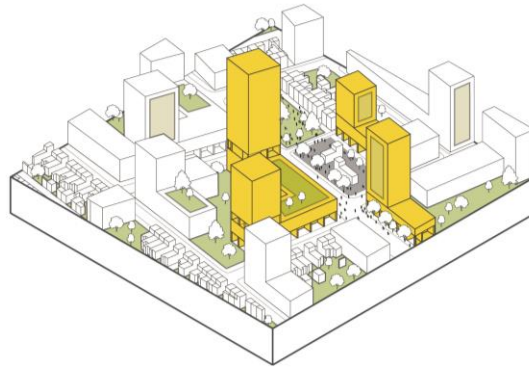
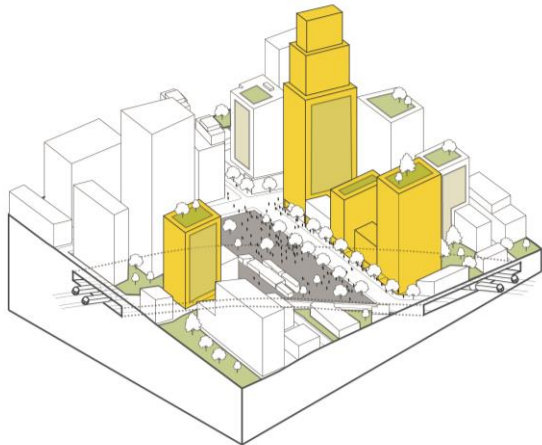

More detail and discussion in a moment!

10. Housing Diversity



Local level – simple principles

Mixed building sizes and combinations rather than uniform sizes and combinations

Excellent individual building design with variety of look and feel

Reduction in building size when transitioning to low rise neighbourhoods – new with old

Ground floors that have activity and that are attractive – active streets

A heart for each new precinct – a great public space with many activities – serviced by day to day community and retail services



Density

- Increased access to way of living
- Ease of moving around
- Improved public realm
- Social and cultural facilities
- Greater Housing diversity
- Preserved areas of character



Taller buildings

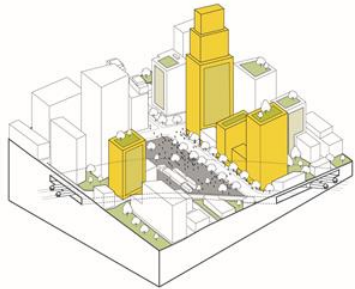

Gradients of height

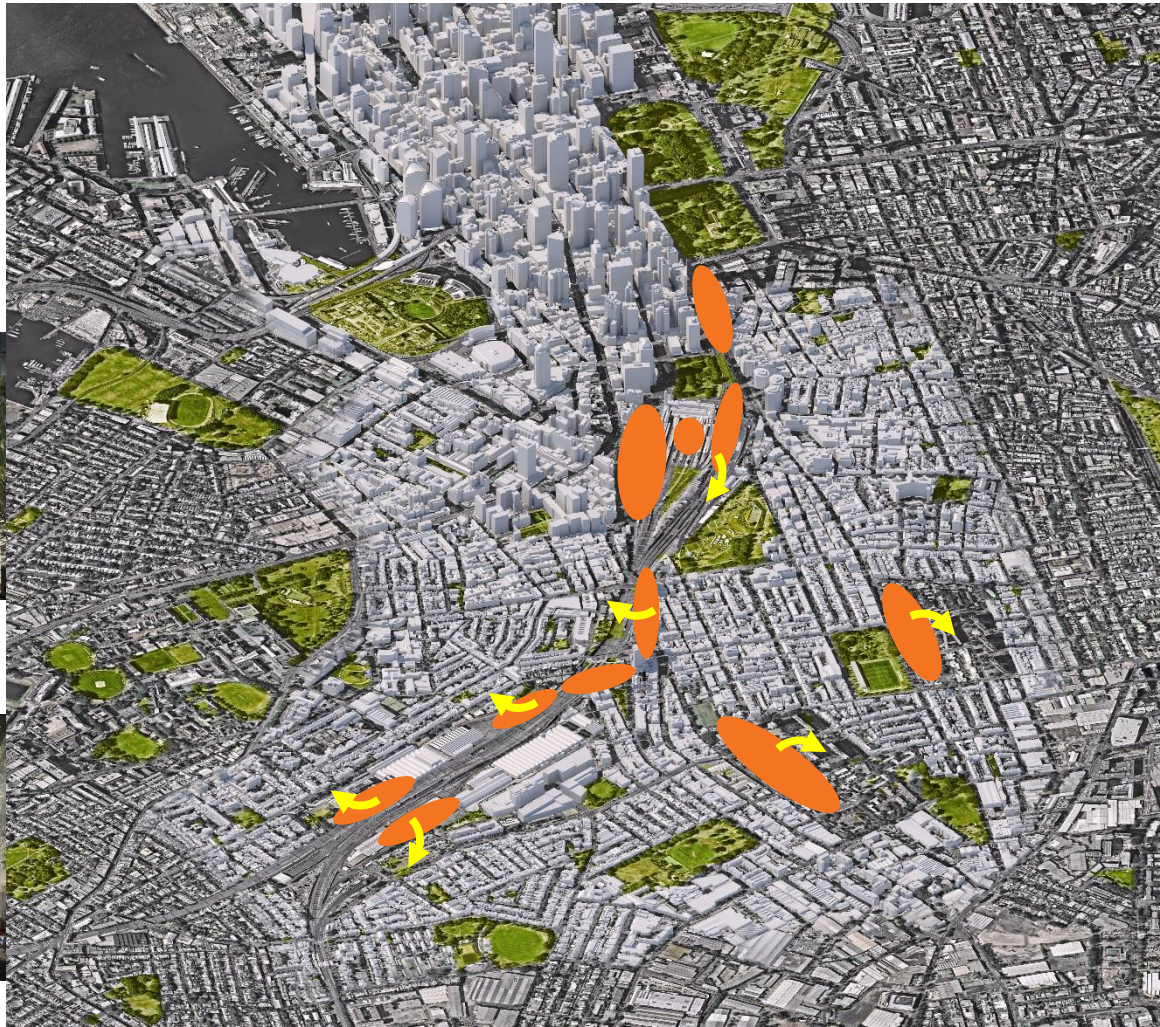
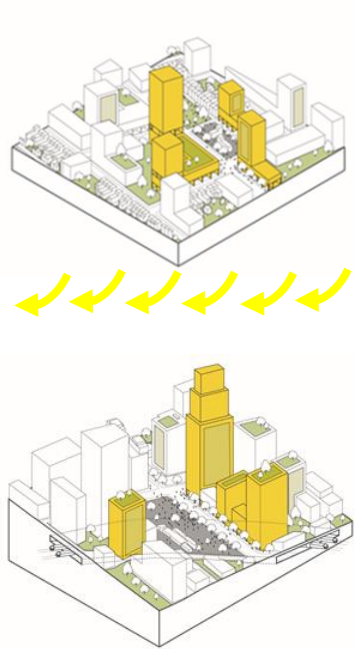

Integration in existing

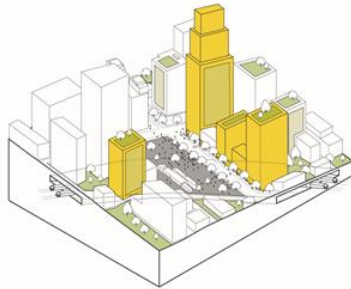
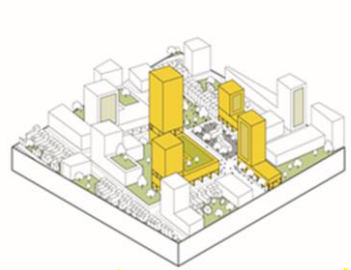
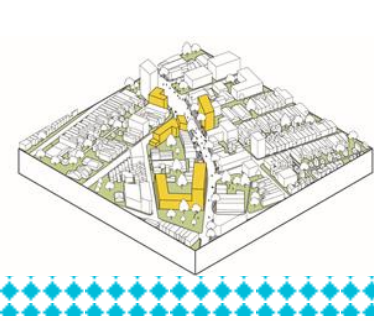

Integration into existing

(Working draft indicative only)

Corridor Massing Strategy

Short Term :
opportunities
include sites which
are not dependant on
development over the
operational railway
and areas which
could be developed in
conjunction with station
development projects



Integration into existing

(Working draft indicative only)



Corridor Massing Strategy

Longer Term:
opportunities
include sites which
feature development
over the operational
railway



Integration into existing

(Working draft indicative only)

Study Area
Massing
Strategy



Local level – simple principles

Mixed building sizes and combinations rather than uniform sizes and combinations

Excellent individual building design with variety of look and feel

Reduction in building size when transitioning to low rise neighbourhoods – new with old

Ground floors that have activity and that are attractive – active streets

A heart for each new precinct – a great public space with many activities – serviced by day to day community and retail services



A community heart
Variety in building size and shape
Variety in feel +
New and old working together
Active and interesting at street level
Example North Eveleigh (West) – examples only subject to change following community feedback

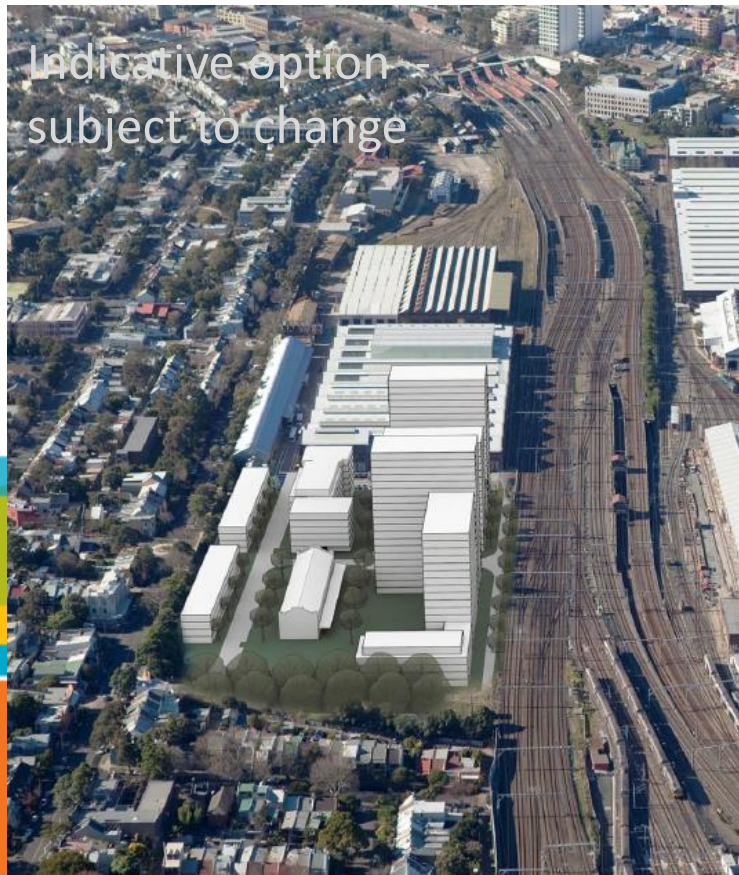



Spacial Plans

Troy Daly



Planning principle maps - context

Urban and transport framework



Study area renewal strategy

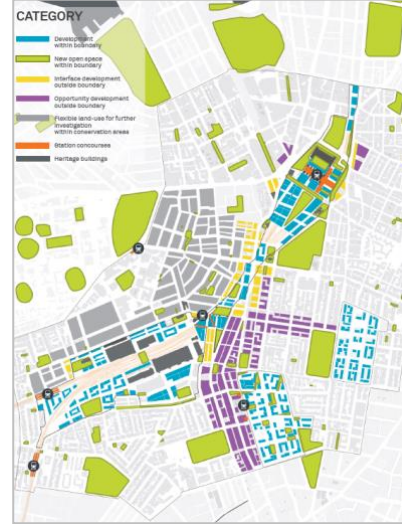

Community facilities and open space



WORKING DRAFTS
SUBJECT TO CHANGE

Land use and
heights etc

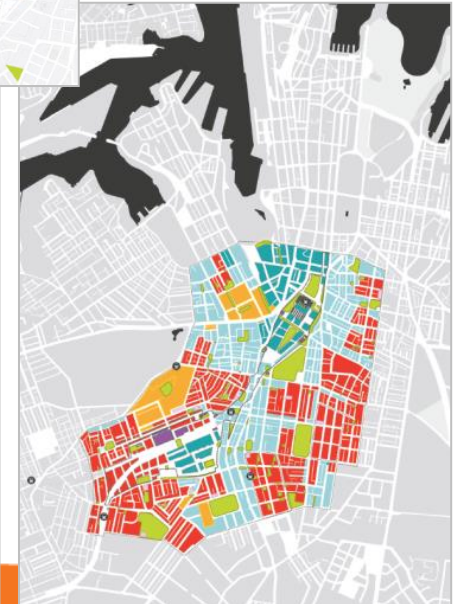



Places and Open Space

Planning and Implementation

Kerrie Symonds



Vision: A green network



A wider green network, streets and pathways, that connects local activities, parks, public places and community

- Active and attractive public places
- New public meeting places and parks to encourage greater interaction with neighbours
- Expanded local bicycle networks
- 5 minute walk from each home

What we've heard so far

- Need for green space in an urban environment
- New open space to meet the needs of increasing population

- Broader choice of open space (diversity)
- Health & environmental benefits
- Sense of community

"Small parks will result in familiar environments which will result in community belonging"



Create a green network

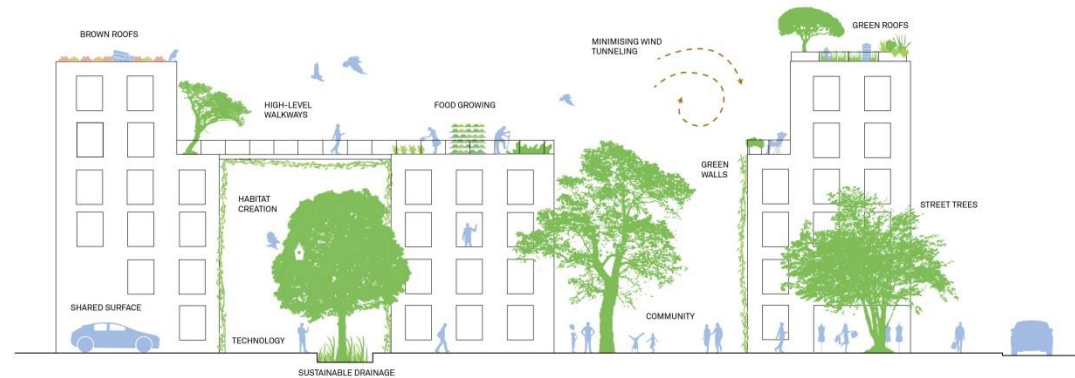

- New open space
- Enhance & better utilise existing amenity
- Green streets
- Green walls, roofs and “infrastructure”

Quantity, quality, accessibility, diversity

The role of places and open space

Connector



GREEN LINKS

Deliver a green spine between Erskineville, Newtown and Central Station that extends the Goods Line to encourage local active transport and regional tourism.



HEALTH AND WELL BEING

Provide access to quality public open space within a five minute walk for all.



LEGIBLE + ACCESSIBLE

Use the green spine to establish a green grid that effectively connects the public realm within Central to Eveleigh and to Hyde Park, Sydney Park, Moore Park and Victoria Park.

Placemaker



IDENTITY

Strengthen the identities of existing communities in particular by realising the Eora Journey to better physically and historically connect Redfern, Eveleigh and the CBD.



ACTIVATION

Enhance the public realm to improve the setting for existing heritage assets: Chief Mechanical Engineers Building, Carriageworks, ClothingStore; and Redfern Station building.



COMMUNITY

Deliver civic spaces at Central and Redfern stations to provide a focal point for community activities and different experiences along the green spine connection.

Protector



GREEN NETWORK

Provide a linked green infrastructure network incorporating multi functional design accommodating sustainable drainage, food growth, linked systems of street trees, pocket parks, green walls, wetlands and parks.



MULTIFUNCTIONAL & ROBUST

Design flexibility into public open space to allow for different uses and improved quality over time for example: Prince Alfred Park connected with vertical schooling on Cleveland Street.



URBAN BIODIVERSITY

Using a multi layered approach to integrated green infrastructure that promote urban biodiversity design to support priority flora and fauna species.

Design Principles



- Active
- Co-located
- Safe
- Flexible
- Solar access

Next Steps

- Implementation Strategy
 - Costs & Funding
 - Program

- Public realm and landscaping strategy
 - study area wide design
 - existing amenity improvement
 - street improvements
- Precinct planning design
- Community input
- Work with City of Sydney





Community Planning and Implementation

Kerrie Symonds



What we've heard so far



Community – a place that celebrates our rich diversity and heritage and gives everyone easy access to community and cultural facilities

- Schools, health services, aged care and community facilities;
- Specific needs of housing tenants;
- Management models for community facilities;
- Need to explore the community's sense of place and identity;
- Build on existing community infrastructure.

The community

- 30,000-56,000 additional people
- Significant diversity:
 - cultural
 - income
 - education.
- Older tenants, particularly single persons;
- Disabilities and mental health issues;
- Aboriginal and Torres Strait Islanders;
- Proportion of school children anticipated to grow from 4.7% to 6.3%
- Proportion of those over the age of 70 anticipated to grow from 5.1% to 10.1%

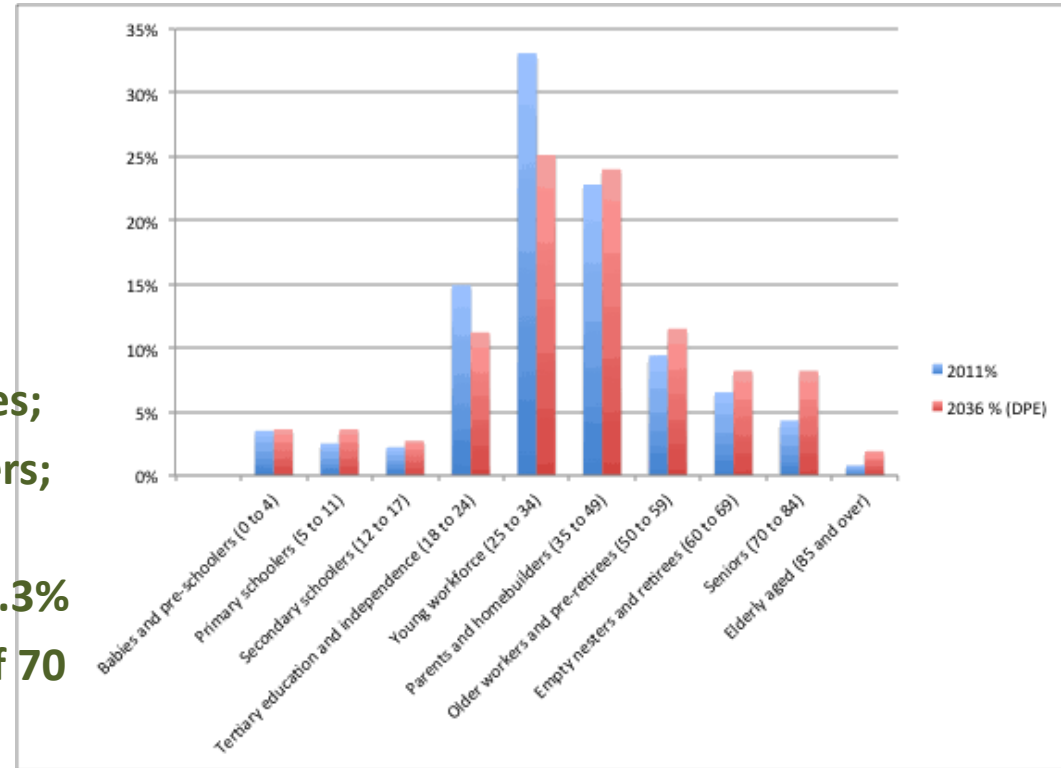

Education facilities

Existing provision

- Primary: Darlington (337 students), Erskineville (375), Ultimo (311), Bourke St (301)
- Community: Alexandria Park (611)

Proposed provision:

- Working closely with DoE to ensure demand is met
- Cleveland St High School (up to 1500 students)
- Ultimo Public redevelopment
- Additional permanent classrooms to meet demand



Health facilities

Benchmarks:

- Comprehensive Community Health Care – 100,000-150,000 people
- Integrated Primary Health Care – 15,000-20,000 people



Proposed provision:

- Working closely with Sydney Local Health District to develop plans for Integrated Primary Health Care or Community Health Services
- Ensure demand for beds and services at RPA hospital is met with SLHD
- Ensure provision of flexible spaces in community centres for community health staff services
- Provide commercial floor space suitable for General Practitioners

Multi-purpose community centres

Research/benchmark:

- Populations under 20,000 – upgrade existing centres

Proposed provision:

- One in each precinct – the ‘heart’
- Different focuses – cultural, enterprise/work, high need users, health
- 250m² to 2,225m² in size (dependent on density)

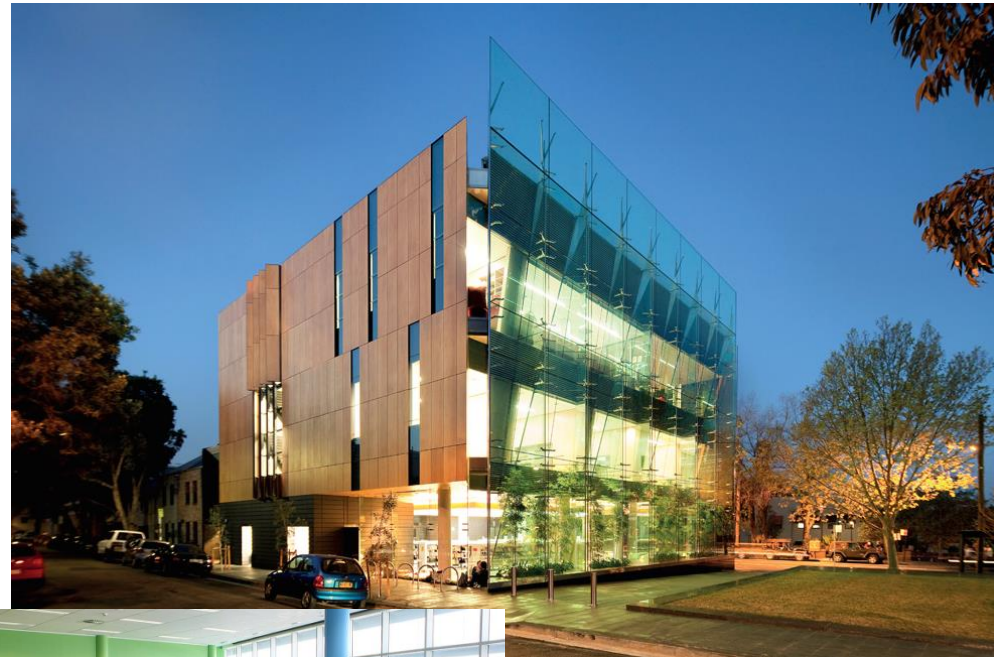

Child care centres

Research/benchmark:

- 1 place for every two resident child aged 0-5 + 1 place for every 75 workers

Proposed provision:

- 5-9 child care centres (will depend on final density)
- Delivered through a range of measures – in partnership with City of Sydney and developer provision



Libraries and cultural centres

Research/benchmark:

- One cultural centre for every 50,000-150,000

Proposed provision:

- Part of the Clothing Store for community/cultural use – 800m²
- Funding toward the existing City of Sydney libraries



Proposed Provision



- Additional classrooms
- Health facilities to meet demand
- 6 Community centres
- 5-9 Child care centres
- Assistance to City of Sydney for provision of facility at Newtown

Next Steps

- Community input
- Strategies to support community cohesion and development
- Short term activation of The Clothing Store
- Ongoing evaluation with Education and meets demands
- Social Impacts Assessments during precinct planning
- Ongoing monitoring and evaluation





Heritage, Arts and Culture

Planning and Implementation

Vanessa Gordon

What we've heard so far



“Make a strong arts, cultural and heritage area even stronger and secure in its future in Sydney’s cultural landscape”

- build on the existing arts, cultural and heritage strengths of the area
- strengthen the capacity of existing arts and culture sectors and foster connections
- celebrate Aboriginal culture and consider a cultural precinct
- adaptive reuse of heritage buildings
- tell the stories of the rich rail heritage and diverse communities
- Integrate into planning

Presentation name 52

Benefits

- bring a sense of convergence – current and new communities.
- the international to the doorstep and launch the local to global strengthening Sydney's position
- urban environments that surprise and delight, offering unique experiences
- foster innovation, business and outstanding fine grain development.
- establish a sense of place.



Landscape









- Proximity and lines of connection – rail lines, story lines
- Multi-layered with stories
 - Aboriginal
 - culturally diverse
 - rail and also industry
 - social activism and justice
 - Natural – wetlands
- Placement of creative industry/enterprise
- Support the Eora journey
- Chemistry through temporary programs
- Engage community and partners





Integrating creative practices, establishing a place brimming with endeavour and new ideas; where commerce and culture collide to create a dynamic sense of place.

- 
Station Squares

Cultural / Arts
- 
Pocket Parks
- 
Local Parks
- 
Childcare Centre
- 
General Practice Health
- 
Multi-purpose Community Centre
- 
Community Health
- 
Enterprise Hub

Heritage building



New community facility



Local park

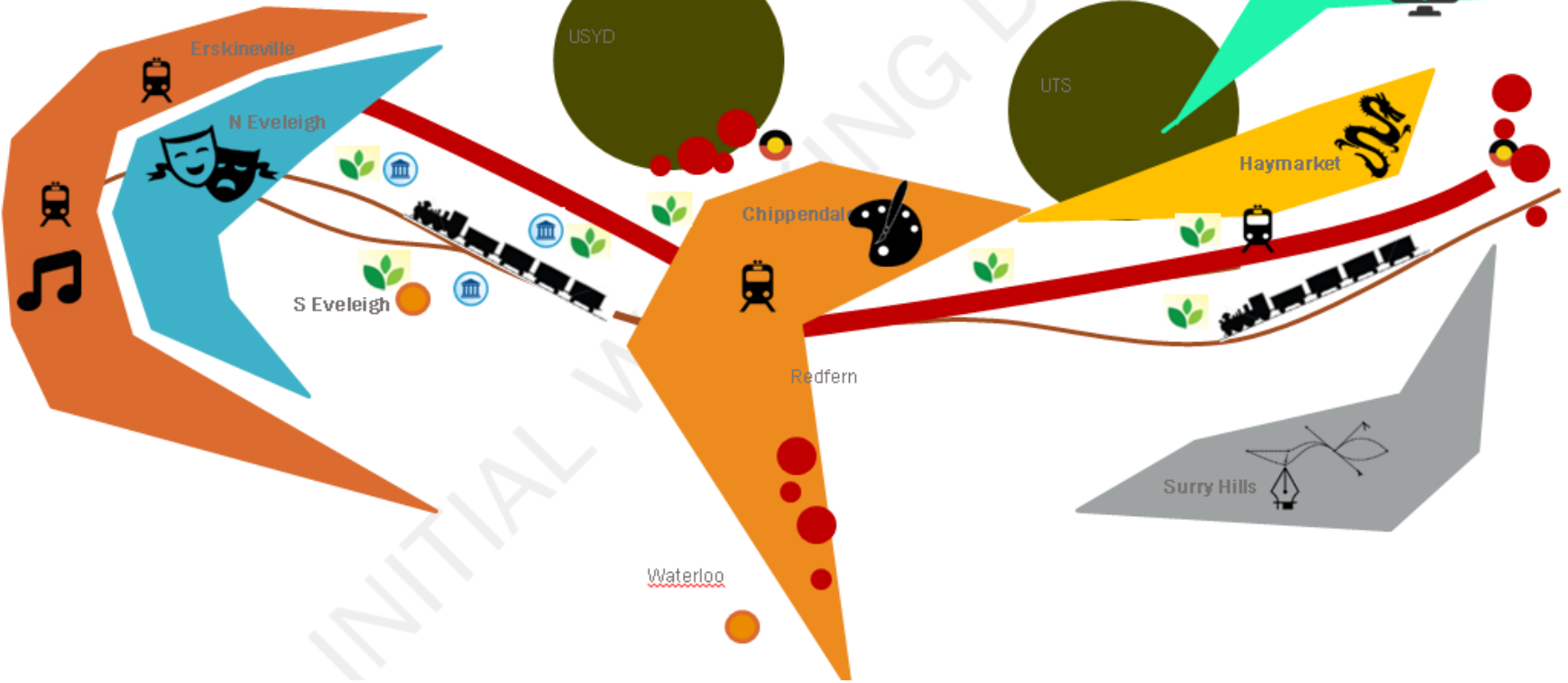

Activities

- Placemaker
- Detailed public art strategy
- Detailed heritage strategy
- Events and short term activation
(Clothing store and other opportunities)
- Online interpretation and stories
- Sustainability - future developers
 - Establish brand / place
 - Embed principles in agreements



Oversight 3-5 years

Dependent on stakeholder engagement

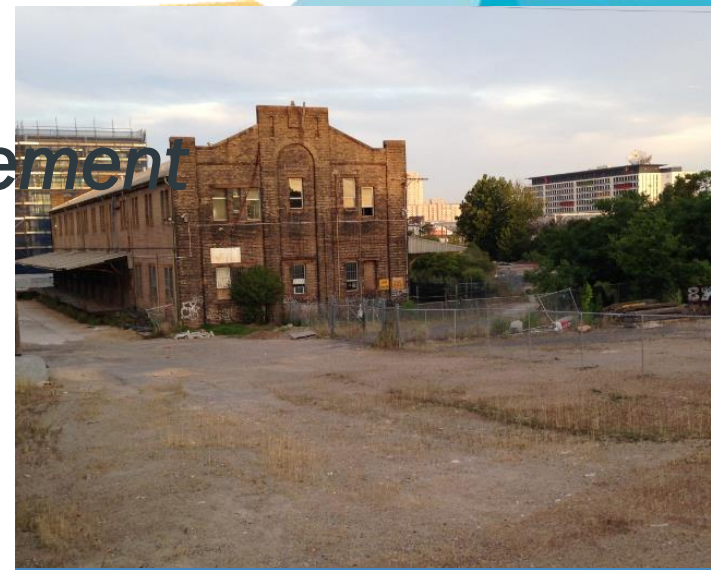



Feedback and close

